



G9 | Pit Less lift



This product won the Taiwan Excellence Award



Taiwan, Japan's technical cooperation

Sakura Elevator Japan Co., Ltd. is headquarter in Tokyo, Japan, an elevator company that markets the world. Tadashi Hidetaka is head of the head office and has a market spanning thirty of Japan, Singapore, Southeast Asia, the Middle East, North America, Central and South America, and Africa Yu Guo, and set up branches in many countries and regions (including Japan, Taiwan, Singapore, Hong Kong, mainland China, Indonesia, the United States, Guam, etc.).



President Nippon Sakura
Hideki Ota

Taiwan "Sakura Elevator Co., Ltd." is Taiwan, Japan joint venture to Taiwan as a manufacturing base, products to meet the needs of customers around the world. In the wave of globalization, Sakura Elevator uphold the research and development team from Taiwan, Japan continued continuous

research and development, innovative products, adhere to quality, in order to meet the Japanese product world-class image.

Sakura Elevator Japan headquarters stationed in Taiwan's quality control minister Tsukamoto letter method (NOBUNORI TSUKUANA), for each elevator have been under strict quality control, and in 2009 won the European CE certification.



Quality Management Minister
NOBUNORI TSUKUANA





Sakura Elevator, a renowned elevator manufacturer, sell across Japan, Singapore, Southeast Asia, the Middle East, North America, Latin America, Africa and more than thirty countries. As manufacturing based in Taiwan, Sakura' s innovative elevator focus in quality with AMADA machinery to produce one of the kind elevator for every customer. In Taiwan, Singapore via international marketing strategy which lead Sakura elevator to become global leader in elevator world.

Each every Sakura elevators has undergo a rigorous quality control and won a number of international quality recognition, the European CE certification (elevator machine) in 2009, it is not only the company's glory, but also the entire Taiwanese pride, and the other also received the awarded Japanese government's (The protection device against the elevator doors open in accidentally movement) anti-smoke doors and other certifications, and certified by UCMP Europe in 2014.



Index

P 2-3

About Sakura Elevator

P 4-5

International scale manufacturing equipment

P 6-7

Complete service system

P 8-9

G9 new inorganic pit elevator

P 10-11

Small-scale buildings

P 12-13

Easy installation of the elevator

P 14-15

Minimum space requirement

P 16-17

G9 elevator car decoration

P 18-19

I TOUCH + user interface

P 20-21

G9 economy 2 models

P 22-23

Host Control I-POWER

P 24-27

Selection of features + size requirements

Green, environmental protection, energy saving

Green energy-saving elevator is cherry green efforts, energy-saving LED to replace the traditional halogen lamp, the service life of 10 times longer than the halogen lamp, power consumption than halogen lamps 80% energy saving.

If the elevator reaches the preset time, it will automatically switch to standby mode, compartment lighting will automatically turn off, the information display system will be dark, compartment fan will automatically shut down, so as to achieve energy-saving effect.



Customer safety is cherry quality assurance

Sakura Elevator will be regular staff education and training, customers use the elevator can have a safe quality, if the customer in the elevator operation process, but a failure will automatically stop the elevator operation. Repair staff immediately repaired, and can run in the shortest possible time, so that customers can feel at ease with our products.





International manufacturers and facilities

Elevator safety and comfort are our main concerns. The pursuit of quality is the common goal of all of our employees. In hardware, we insist on using Japan's AMADA equipment, supplemented by automated production and ISO strict quality control system.



Modern manufacturing

Sakura Elevator Manufacturing Center using advanced production, each component is equipped with special tools for production, to ensure that each piece of Seiko secret agents, to provide customers quality products, at the same time bring customers the fastest product services.



Elevator monitoring and management center

"The elevator is out of order or the person is off, and the manager is informed to call the elevator company." This is a well-known common sense now, and it is also a mode of maintenance that has not changed since the elevator was installed for over a hundred years. Now this mode is to be broken.

You can keep track of the condition of the elevator

SMART MAINTENANCE SYSTEM(SMS)



Elevator fault do not call

When the elevator fails or shut down, do not have to call the elevator company, the elevator will immediately automatically send a message of the status of the fault or the person concerned to the monitoring and management center of Sakura Elevator, the maintainer, the manager of the Sakura Elevator service and the client's designated Relatives and friends in four places, so safety is not dead!



Fast and error-proof installation effectively shorten the installation period
 Plug-in connections as well as error-proof connectors should be used in the control system to ensure that no incorrect connections occur. Provide three-dimensional graphical and accurate installation guide, greatly improving the efficiency of the installation.

Tailor-made professional team





This product won Taiwan Excellence

The Taiwan Excellence Award is held by Bureau of Foreign Trade and executed by Taiwan External Trade Development Council.

The annual national award is for marketing Taiwan products. The Taiwan Excellence Awards to a rigorous and stringent selection system that covers four major aspects of "R&D"、"Design"、"Quality"、"Marketing" and "Made in Taiwan".

Products that have been selected for the Taiwan Excellence Awards are not only capable of creativity in research but also have strength to expand their external trade.

G9 Pitless Elevator

Pitless Elevator Unibody Design

Best Choice For Your Current House

新型ピットレス エレベーター

Why do we need the pitless elevator?

A normal elevator needs one-meter- deep pit, and the pit will affection the construction of the building.

Suitable for
2 ~ 5 floors
buildings

Pitless elevator will avoid piping, wiring, and building structure.

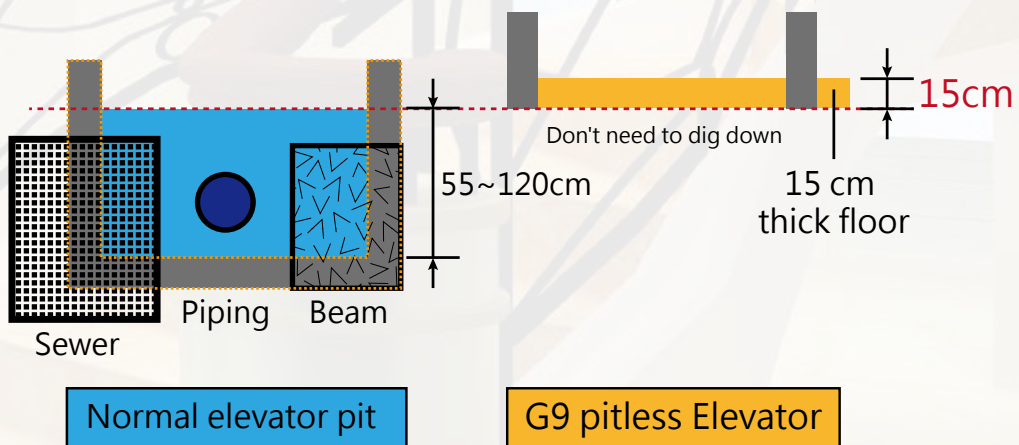

サクラ エレベーター

G9 Pitless Elevator
Unibody Design

EU CE
certificate



Take a new life

SAKURA Home Elevator elevates every floor of your home. The applicability of your life for added convenience. Whether it is The elderly, children, furniture, daily necessities, clothes to be washed Service, or hospitality guests need to repeatedly move up and down the house, We are sure you will find our home elevator. For your current home or new home adds practicality and tone reason. Whether it is a new home or resale more attractive Buyers, thereby increasing the value of residential.



SAKURA lift can solve your household inconvenience

For house chore

Having a lift makes it easy to do housework and carry heavy loads

For elderly people

Having a lift elderly easy to have fun with family

Your home is usually one of the biggest investments you've made in your life. Now you do not have to move because you or your family have trouble getting up and down.

Japanese questionnaire for home elevator installation

Reason for elevator installation	
NO.1	For future use
NO.2	For elderly people
NO.3	For lifting heavy stuff
NO.4	Up and down stairs inconvenient
NO.5	For the disabled

重視電梯的項目?	
NO.1	Product reliability
NO.2	Convenience
NO.3	Easy to operate
NO.4	Safety
NO.5	Elevator have handrail

The space for installation is less than 2 square meter



How to install the elevator at home?

To give your family a comfortable lift. SAKURA elevator provides security, convenience, and trustworthy quality to your family member.



Easy Construct

G9 Pitless Elevator - Save Space

an normal elevator needs more space to construct, which will damage the building structure

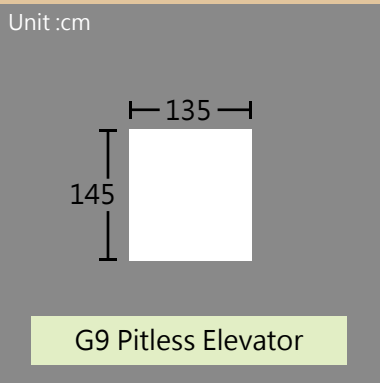
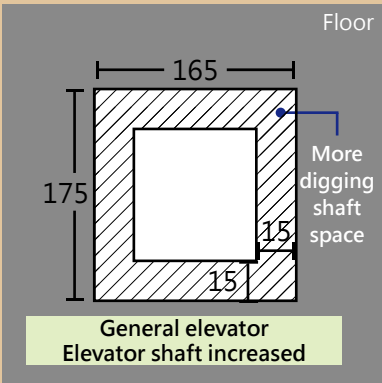

G9 pitless elevator comes with aluminum shaft, requiring the least space for shaft

Less Space

Building structures can be installed with G9 Pitless Elevator

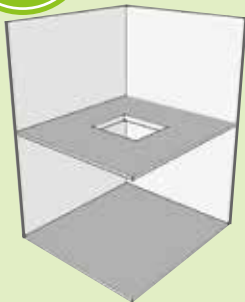

Elevator installed inside Building

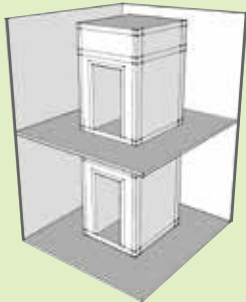

cutting the "hole" on the floor for the shaft

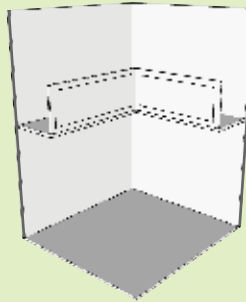

Existing "shaft space" in Building

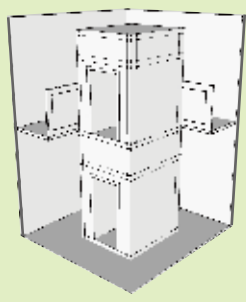

Putting aluminum shaft in the lobby

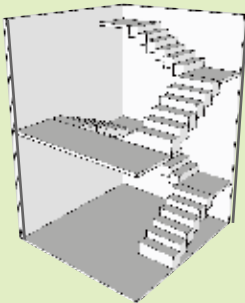

Around the middle of the stairs

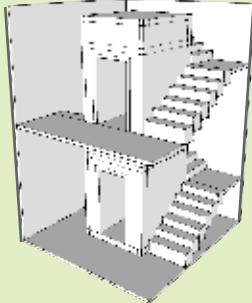

putting aluminum shaft in middle

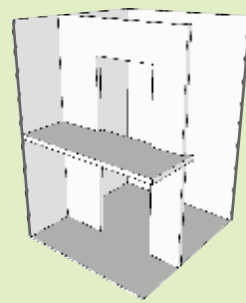

no space for elevator shaft

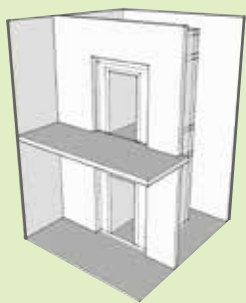

Putting elevator shaft outside the house

Cost Less

Buildings suitable for G9 Pitless Elevator

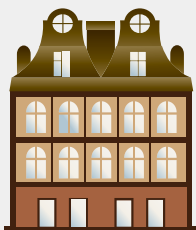

Villa



Single-family House

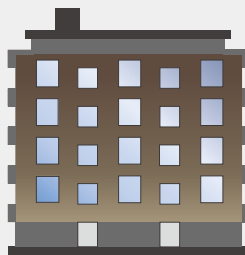

Condominium

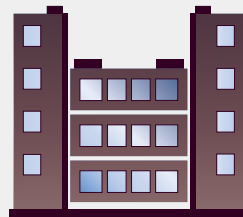

Apartment



Dormitory

SAKURA Elevator original **minimum hoistway space requirements**, so that the installation of the elevator villa, becomes easy and simple



New Product
130cm

Pitless Elevator can be installed in less than 130X140cm space

Because it's pitless, it won't damage the ground beam and sewer underneath

- Synchronized with the Japanese market, authorized in Taiwan to design, manufacture

Compact design to save more space

SAKURA home elevator one of the most prominent features, take up the smallest building space, to provide customers with the largest use of space. Unique drive and structural design make our products unparalleled advantages. No matter what your home is like, our home elevator gives you the most space-saving solution.

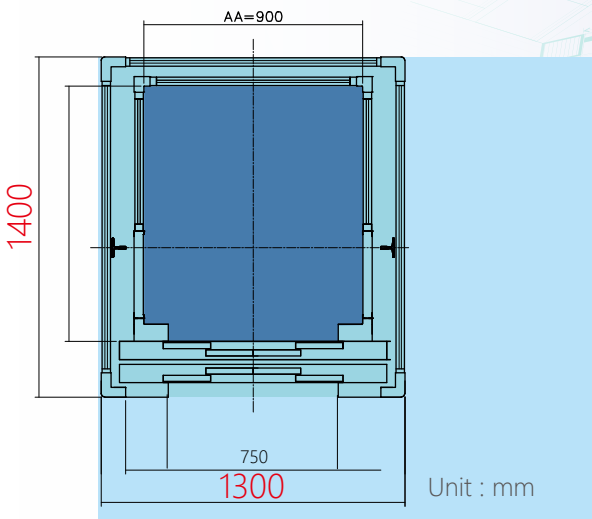

1800
15cm

Make the most efficient use of space so that wheelchair users or people with limited mobility can enjoy the ride



Hoistway layout

4 people

Wheelchair ride

900mm

900mm

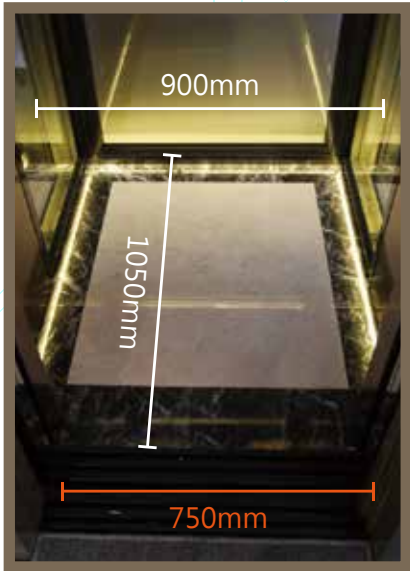
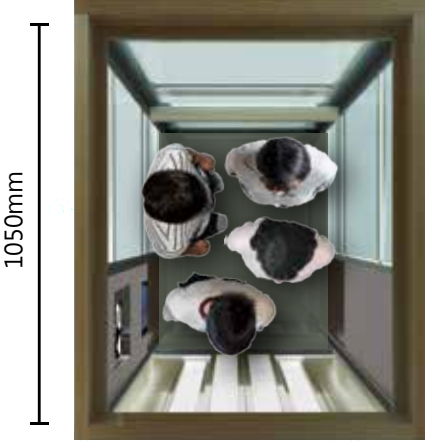

G9-L (LUXURY)

Elegance in design



If no one uses the elevator, the cabin will go to the designated floor



Energy Efficiency

SAKURA Elevator also provide high quality and various customized designs



Teak Tree White
LNW-12



Delegate leather handrail and hidden lighting

Cross Grain Gold
LK-RS03



Please read the manual carefully to understand the maintenance procedure



Voice System



Touch Screen



Elevator Setup

Touch panel / LCD multimedia display HOP

- Status and Record
- Elevator Control
- Operation Manual
- Maintenance Record
- Intercom and Siren



LCD Display



Big Button

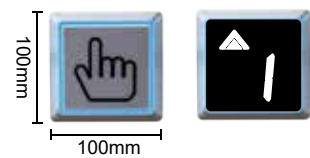

Big Button - easy to touch when your hands are carrying groceries

Aluminum Shaft Design

Optional



Wood Pattern

R41

Black

780-49098FITM

Champagne Gold

780-490011M

Elegant design, quick and easy installation, when the customer does not provide reserved hoistway, we can provide a metal frame to install the elevator, customers can choose according to preferences and floor decoration style different materials.

Elevator door style selection

Optional

Infrared Safety Door Sensor

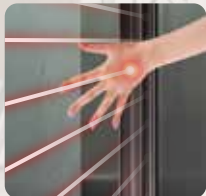

Infrared Safety Door Sensor has pass TUV certificate, providing safety and stability to our customers



Transparent

Dark Brown Transparent

Baking Opaque Glass

Premium Sedan Devices



Air Conditioner

For Premium Sedan, Atmospheric Lighting



Atmospheric Floor Lighting

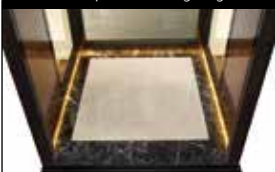

Delicate Leather Handrail

Optional



Gray Leather (6042)



Dark-Rosed Leather(6027)



Wheel Chair and Nurse



The cabin size is enough for a wheel chair and a nurse

Elevator Malfunction Notification System

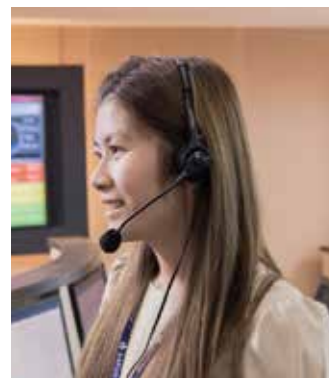

SAKURA elevator is equipped with the instant surveillance system. Any malfunction - accidents and electricity breakdown will be notified

The above product styles are for reference only, the style is based on real products



Full Touch
Interface Elegance
Cutting Edge Technology



Full Touch I-TOUCH System

Status and Record



Elevator various functions into home page

Maintenance Record



Enter the elevator maintenance system



Elevator Control



Various functions of the elevator control system

Intercom and Siren

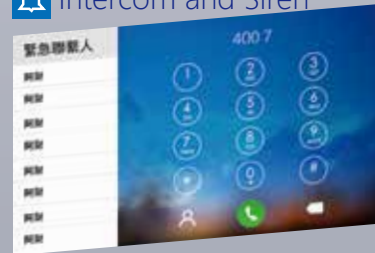

Emergency contact or contact list

Manual



Elevator use, maintenance use function

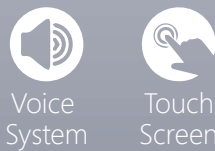

Cabin Light Selection



S107
G9 Simplicity Style
Premium Swipe Sensor



The elevator can be entered with a swipe card or the password

Optional

- ◆ High data collection density
- ◆ Anti-interference ability
- ◆ Small functional loss, light weight
- ◆ More stable performance
- ◆ Dedicated card reader module
- ◆ Provide communication methods



Optional

S106
G9 Simplicity Style
LED Light Adjustment



New Generation LED Series

Providing multiple design choices to satisfy every customer's needs. The cabin interior design is integrated with the LED module.



Atmosphere and Mood
Customer can change different colors every day

G9-SA (STANDARD)

Elevator Interior



Stainless Handrails

Curved Handrail



Flat Handrail



Atmospheric Lighting

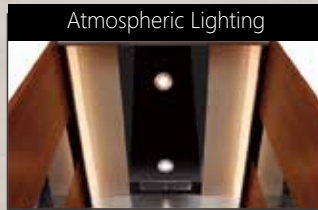

PVC floor X-7202



Touch panel / LCD multimedia display

HOP



Phone contact

SAKURA elevator is equipped with a phone. When an emergency occurs, passenger can contact the service center

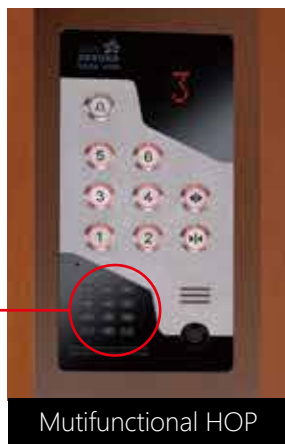

Elevator door style selection

Optional

Infrared Safety Door Sensor



Infrared Safety Door Sensor has pass TUV certificate, providing safety and stability to our customers



The above product styles are for reference only, the style is based on real products

G9-SB (STANDARD)

Elevator Interior Premium Sedan Devices



Stainless Handrails

Curved Handrail



Flat Handrail



Atmospheric Lighting



PVC floor X-7207



Color

Optional

Teak
LW-9284



Oak
LW-1002



PVC
X-7202



PVC
X-7207



Big Button

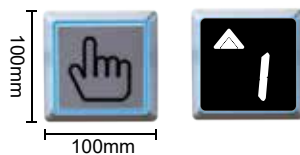

Big Button - easy to touch when your hands are carrying groceries

Wheel Chair and Nurse



The cabin size is enough for a wheel chair and a nurse

Elevator Malfunction Notification System

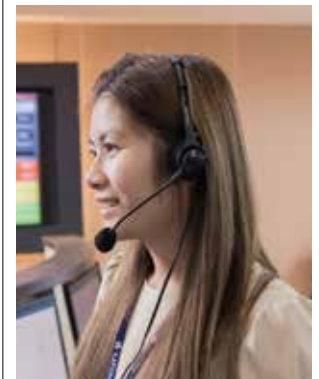

SAKURA elevator is equipped with the instant surveillance system. Any malfunction - accidents and electricity breakdown will be notified

The above product styles are for reference only, the style is based on real products

Traction Machine I-POWER

Cutting edge technology and elegance design

The latest 4th generation power system, it combines the controlling and inverter system.

The system I/O is simple to use, diagnosed, and repaired.

The system also has IE remote monitoring function, PDA operation, N curves, safe landing, floor parking, backup power, and so on.

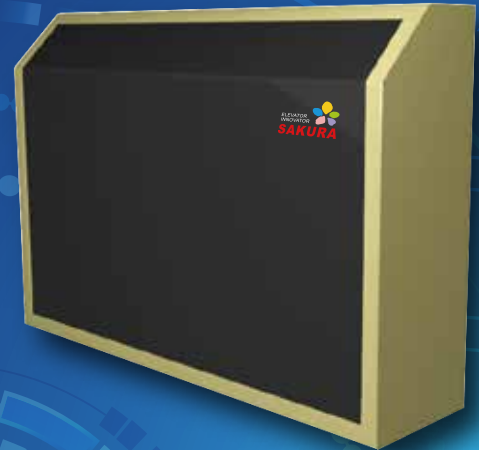

Easy
Installation

Space
Saving

Easy
Maintenance

User
Friendly





I-POWER Safety Function

Electromagnetic Brake	When the elevator park and power failure, the "spring tension" and lining will stop the traction machine to prevent the cabin and the counter weight from falling off.
Governer	If cabin and counterweight descend abnormally, the power will be cut off to stop the cabin, the brake will also come into force.
Instant Brake	If the cabin descend too fast, the gripper will come into force to slow it down.
Pit Bumper	When emergency happens, the pit bumper will reduce the shock.
Landing Door Lock	The landing door can only be opened when the cabin arrives, or user unlocks it with a key.
Cable Tension Detector	The detector will the tension of the cable to ensure the safety
Power Protector	To prevent the traction machine from running backwards.
Power supply abnormal protection device	Winding motor power phase failure or reverse phase, the timely interruption of power supply, so stop running.
Overload warning function	Elevator mounted weight exceeds the rated load, touch the scale device. Will send a warning signal, and make the elevator door can not be closed , the elevator can not start.
Light curtain safety door edge	When entering the elevator, passengers are detected in the doorway, the elevator door will remain open.
Upper and lower terminal deceleration - Limit stop switch	If the elevator exceeds the "terminal forced deceleration switch" and "terminal limit switch" is still due to abnormalities, but can not stop the elevator, the line will finally touch the device and then stop the elevator immediately.
Interphone	Contact the car and the building management room of the elevator dedicated call equipment
Emergency Lighting	In order to ease the mood of the passengers, immediate switch to the emergency light in the compartment during the power outage.



Optional features

(UPS)

In the event of a power outage in a building without a generator, drive the carriage to the nearest floor and open the door to evacuate passengers in the elevator.



Earthquake control operation



When an earthquake sensor detects an earthquake, the elevator will travel to the nearest floor and open the door to evacuate passengers in the elevator.

GSM

If there is a fault in the elevator system, it will automatically send a text message to the designated maintenance personnel or customer service center.



Near-end monitoring system



Use the transmission line to monitor the elevator status, car status and fault records

Voice function

Broadcast automatically to passengers in electronic language to provide peace of mind to the visually impaired or passengers unfamiliar with the lift and provide multilingual



Open the door to extend the function

When the elevator takes a long time to load or carry goods, press this button to extend the door opening time.



Password called car



In designated floors, restrictions on the general staff to use this password can enter the floor to ensure the privacy of the building.



Elevator specifications

Lift type		HAL		HRC
model		HAL-G9-L	HRL-G9-S	HRCG9-S
Basic information	Rated load (KG)	320	320 (400)	
	Rated speed (M/min)	20		
	Max travel (M)	15		
	transfer method	Reel Host machine		
	Open the door	2CO		
Car size	(W)* (D)* (H)	900* 1050*2200		
Entrance size	(W)* (H)	750*2000		
Technical Parameters	KW(HP)	4KW(5.3HP)		
	Cable (Quantity / Diameter)	2*10mm		
	guide	8K		
	Hanging	1:1		
	Power requirements	Single Phase 220V30A		
Shaft size	Reserved size (W*D)	1350*1450	1300*1350	
(Pit)	Floor: plastic floor tiles	150		
	Floor: Marble	200		
(O.H)	Power Box at sides	2800 < O.H < 3300 Request Power Box (1300*350*1000)		
	Power Box above shaft	O.H>3300 (Power box place above shaft)		
Cabin Design	Front panel	(Anti-fingerprint) plated rose gold	Cabin Wall	Makeup steel plate + mirror stainless steel
	Inner door frame	(Anti-fingerprint) plated rose gold	Inner door	mirror stainless steel
	Car door	Mirror stainless steel + box glass	Car door	Makeup steel plate ten acrylic window
	Three sides outlook	5t+3t+0.76 (Glued glass)	Handrail	Bright stainless steel handrail
	Handrail	Aluminum skin cover +LED	Patio	Indirect lighting +LED
	Patio	Adjustable color LED		
	Skirting board	Adjustable color LED		
Exterior board	Plate painted + color can be adjusted by LED			
Entrance design	Door frame	Plate painted	Pattern Steel	
	Take the gate	Steel paint + box glass	Pattern Steel +Acrylic window	
Operation panel	Car operating panel	i-touch Smart LCD panel	Vi bration stainless steel titanium + mirror acrylic	
	COP	LCD + Big button	LCD +Big button	
Lifts	Support column	Aluminum painted		Customer responsible by local
	Seal plate	Glued glass : 5t+5t+0.76	Aluminum paint window frame + steel paint Pattern Steel/ customer responsible by local	
Reference Drawing NO.	Power box at sides	E61-C140	E61-C144	E61-C141
	Power box above shaft	E61-C143	E61-C142	E61-C145

G9 Pitless Elevator layout (traction machine on side)

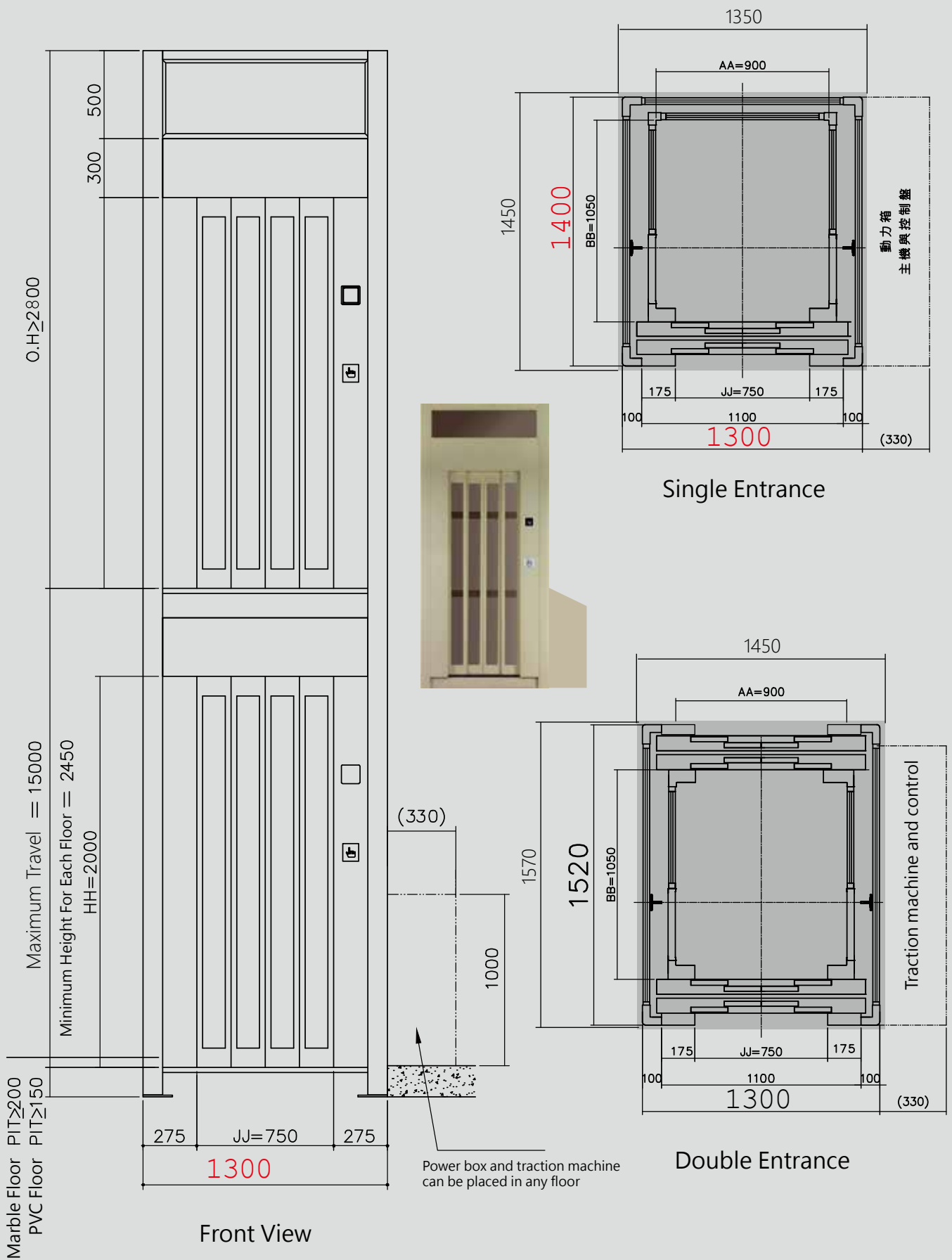

G9 Pitless Elevator layout (traction machine on top)

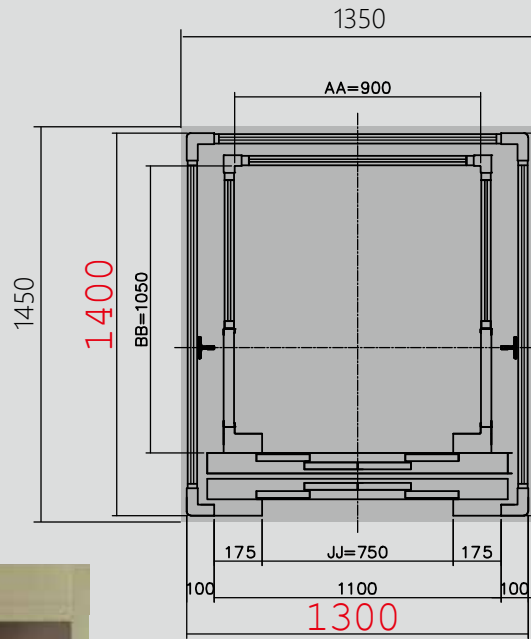
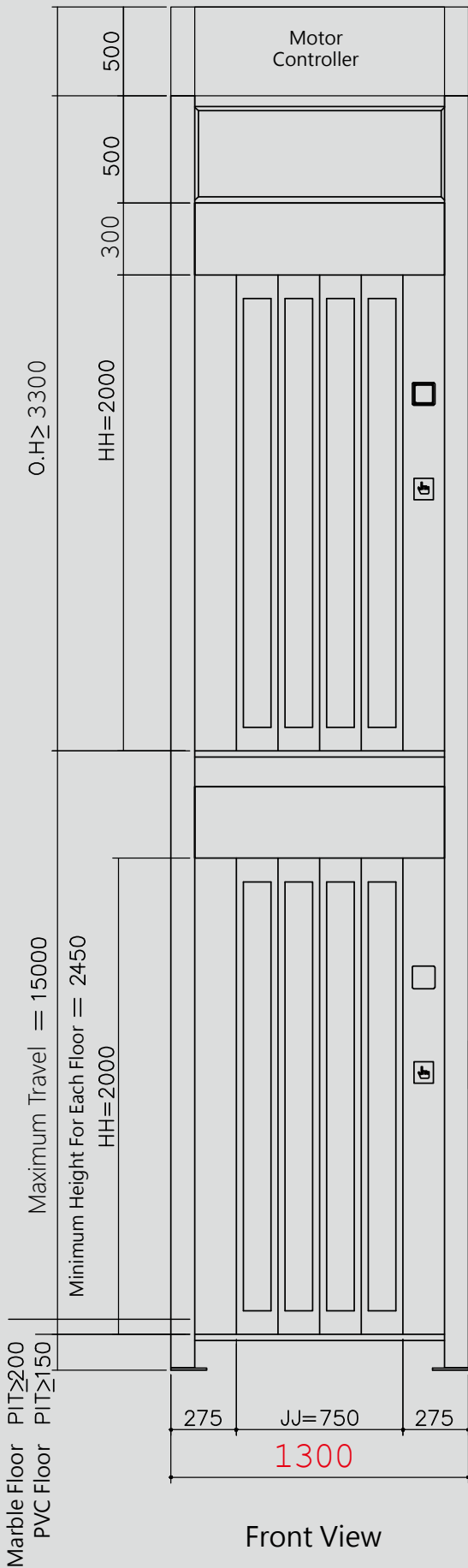

Single Entrance

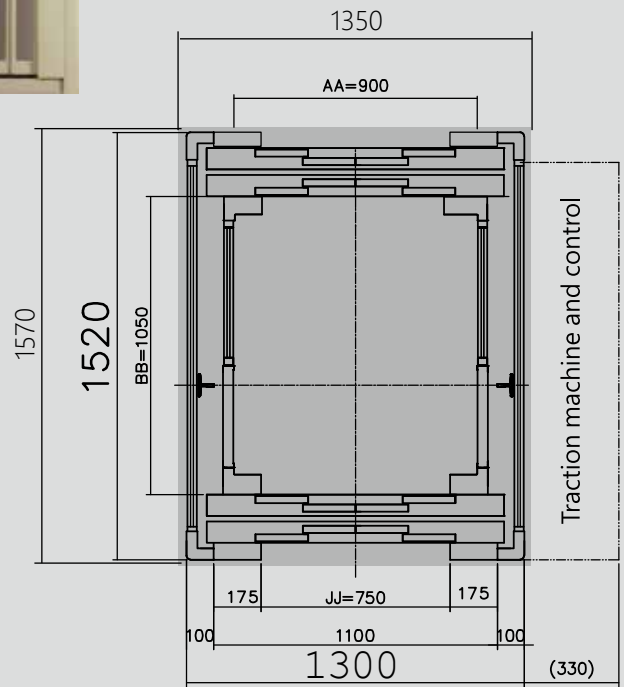

Double Entrance



Taoyuan Corporation TEL:+886-3-313-9668
No.198-215, Sec. 2, Zhong'ai Rd., Guanyin Dist., Taoyuan City 328, Taiwan

Taipei Branch TEL:+886-2-2831-5827
3F., No. 163. Sec. 1, Zhongcheng Rd., Shilin Dist., Taipei City 111, Taiwan

Hsinchu Branch TEL:+886-37-463-799
No.135, Longsheng St., Zhunan Township, Miaoli County 350, Taiwan

Taichung branch TEL:+886-4-2335-9598
No.708, Sec. 8, Huanzhong Rd., Wuri Dist., Taichung City 414, Taiwan

Tainan Branch TEL:+886-6-254-1133
No.56 Zhengnan 1st. S., Yongkang Dist., Tainan City 710, Taiwan

Kaohsiung Branch TEL:+886-7-716-7115
1F., No.7, Wuzhi St., Lingya Dist., Kaohsiung City 802, Taiwan